

### AIR DUCT

Used on roof of air conditioned car in place of individual vents.

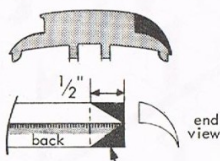

Cut off shaded area (both ends) CAREFUL not to break feather edge. Shape front or top surface, sand smooth. Fit to roof (remove roof beading). See end illustration for finished view.

### REMOVABLE ROOF

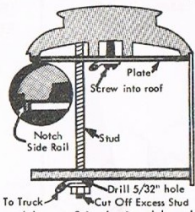

A removable roof is desirable when interiors or lighting are planned. \*U750 removable roof kit makes this easy, provides electrical connection to trucks. For lights (not included) one wire must go to car or loco ahead.

### COUPLERS

Mount couplers on 3/32" pad with #2 x 3/8 screw. For short radius curves, increase 1/2" dimension.

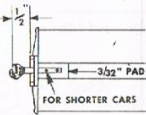

Proper height (center) is 11/16" above rail or 1/4" below floor

### ROOF ROUNDDING

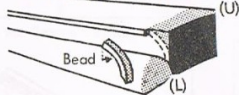

Shape lower monitor (L) Make curved bead from stripwood (or use \*C979 cast bead. Fit to roof. Shape upper monitor (U) to match bead.

### HOW TO APPLY DECALS

**PAINT:** A semi-gloss finish is the best for applying decals. If they do not seem to stick to some finishes. (1) Be sure the surface is clean. (2) Use SOLVASET. (3) Seal the surface first with a coat of dull varnish. NEVER apply a decal until the paint is thoroughly dry.

#### DIRECTIONS

- Trim decal close to lettering to eliminate excess film. WARNING: Hold up to a light so you do not cut into any white lettering.
- Dip in water for 5-10 seconds and set aside on a blotter, towel, or piece of tissue until you are ready to use it. When the decal 'straightens out', it is ready. Don't let the decal float around in a dish of water, as this will wash off all the adhesive. Stubborn decals will loosen faster in warm water to which a few drops of ammonia have been added.
- Slide the decal off the paper, face up, into desired position. If necessary to move it, apply an additional drop or two of water with a toothpick and use the toothpick to move it.
- Soak up excess water with the corner of a blotter or edge of tissue.
- If you are using SOLVASET, now is the time. Follow directions on the bottle.
- Allow decal to dry completely, then apply a coat of dull varnish to the entire model. This will hide the decal film and give a uniform dull finish to the model.

### Decals Snuggle Down with Walther's SOLVASET

Got white spots and blisters on your decals? Use SOLVASET and watch 'em snuggle down and cling to model surfaces like a wet dress on Jayne Mansfield. Yes, SOLVASET makes decals lie flat, drives out bubbles, sharpens detail, eliminates white spots.



### END Decal Glare with Walther's DDV

Now you can have all the advantages of decal lettering without the "shine" or "glare" that bothered the old timers. It's easy. When your model is lettered and done, just give it a final coat of DDV — and you'll have a professional dull finish.



# 9112

O GAUGE  
**THE PIKER**

WALTHERS INC.  
MILWAUKEE, WIS. 53122

Scale: 1/8" = one foot

59-0711

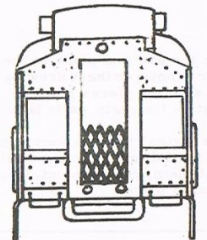
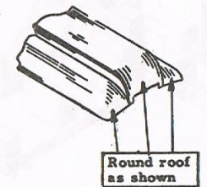
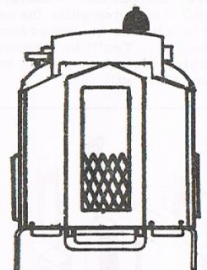
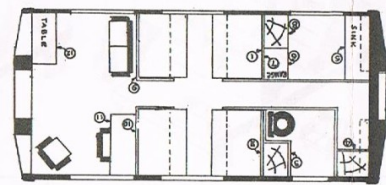
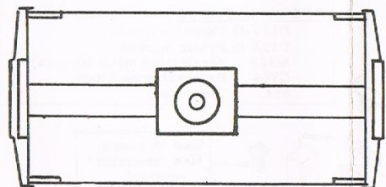
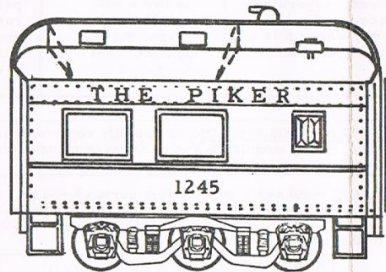
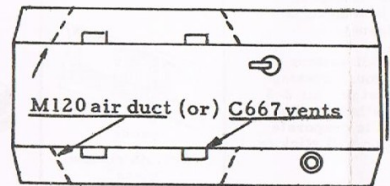

Cementing wood to metal is a job that requires a GOOD adhesive. If you have any doubts about the stuff you've been using, DON'T TAKE A CHANCE. Use Walthers Goo. We KNOW it will hold tight through summer-to-winter attic temperature changes, through the dry-damp periods in a basement, and the inevitable rough handling on a layout.

When you use Goo, please follow the directions on the tube. It is IMPORTANT and to your advantage to coat both surfaces with Goo and let dry for 2-3 minutes before putting the parts together for final assembly. This permits the solvent to evaporate so that Goo can set very quickly. Goo will stick to itself even when partly dried.

If you prefer, you may use the TRANSFER method. Coat one part with Goo, press into place and remove. Goo has now 'transferred' to the other surface. Wait 2-3 minutes while the excess solvent evaporates and tack builds up, then press into place for final assembly. You'll be amazed at the difference this simple procedure makes in the speed with which your joints will set.

Paint and letter outside of sides (See "decaling" on other side)

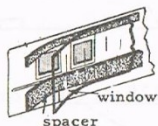

Smooth window "glass" is obtained by compensating for embossed frames with cardboard spacers cut from cereal box.

Tint cardboard interior parts with thin water color. Score all fold lines. Cut out as needed with razor blade and straight edge.

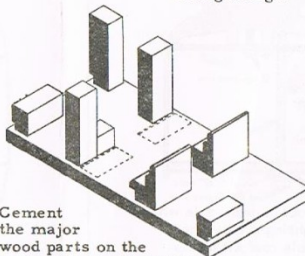

Cement the major wood parts on the printed floor. The sink, range, and table (see plans) must be cut from longer pieces. Check the sides against the body to be sure these parts clear the windows.

Fasten both ends to floor. (Screws and Goo)

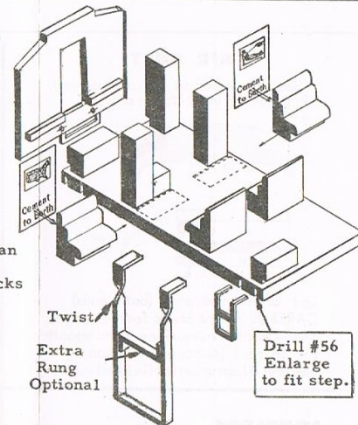

Goo Pullman Seats and Section backs in place.

Twist  
Extra Rung  
Optional

Drill #56 Enlarge to fit step.

FOLLOW THIS OUTLINE to simplify construction and get the best looking model. Half-size O gauge plans are on the reverse. Consult these for any needed dimensions.

PAINT wood and metal interior parts as you go. It will help to put them on a piece of double-face sticky tape (or cement them to a flat surface). Do NOT paint surfaces that will be cemented to the floor or other parts.

**SUPER DETAILS** (not included in kit)

C293 Tailgates  
S120 and S430 hand rails

**OPTIONAL PARTS** (not included in kit)

D119-O Venetian blinds  
D132-O Prism window  
M120 Air duct (in place of vents)  
C964 Removable roof lugs  
S141 Diner door

leave doors open and windows unobstructed to show interior

See plans "over" for removable roof ideas.



cut to fit end

Cut support rails (underside of roof) back 1/8" to clear ends.

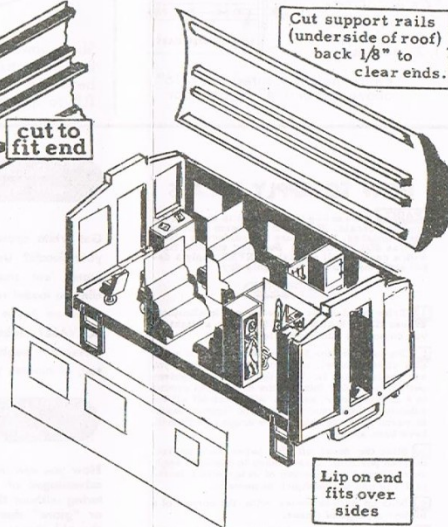

Lip on end fits over sides

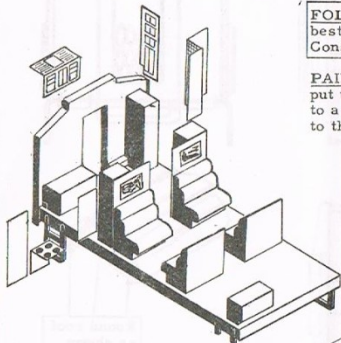

Goo the parts in place in the order shown on these drawings, the smaller pieces going in first -- the main walls last.

The 'extra' lithographed items are for dolling up the plain walls. Tint them, cut them out, Goo them in place.



Goo in place. Use 'transfer' method.

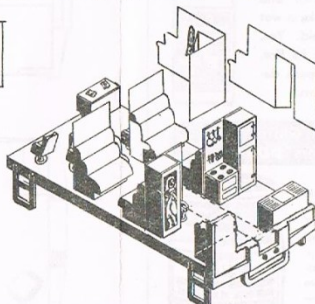

Mount body bolster and couplers on underside of floor. Paint the ends, floor, and underbody. Fit roof to body, paint and fasten in place with two #2x1/2 FHWS. Goo diaphragm on front end. Sides slip inside lugs on ends Goo in place with "Transfer" method

9112 THE PIKER O GA

WALTHERS Inc. MILWAUKEE, WIS.

59-0710 (See also PLANS on Reverse)